



Advantages

- Unique non-intrusive patented scanning system
- Space saving installation
- Advanced patented probe for reliable scanning
- Built-in inspection lens and light
- Leak-free guarantee
- Built-in thermal insulation

Application: Filterhousing with integrated scanning system

Type: Housing

Filter: High airflow HEPA filter, in size 610x610x292 mm. See the relevant page in the catalogue for the technical data about filters

Filter clamping: Suitable for filters, in depth 292 mm. Tool for filter clamping hex key 5 mm

Note: The housing is reversible depending on airflow direction

Accessories:

Replacement kit for scanning system

Lockable handles

Product description:

CamCube AS is a flexible and compact range of scannable filter housings for high airflow (Absolute DG14) HEPA filters and other filter types with 292 mm depth. The cover is a sandwich design with 45 mm heat and condensation insulation between, covered with Aluzinc sheet metal inside and outside (corrosivity class C4). The groove around and between the filters is sealed with sealant to exclude any leakage from the joints.

The service hatch is hinged mounted. The endless gasket on the inside of the service hatch ensure high tightness.

The filter housing has leakage class D according to EN 15727.

When the service hatch is closed the newly developed clamping device ensures the clamping of the filter.

The filter housing is supplied with flange connection and hose connectors for pressure drop.

Scanning:

Using the integrated crank, with foldable handle, the scanning probe can be moved up and down. The scanning process is non-intrusive, easy, reliable and secure and installation footprint is minimized.

The built-in wide angel inspection lens and light makes it easy to look inside the housing.

The scanning system is easy to replace if needed.

Example specification text:

Filterhousing: Camfil CamCube AS-1010.

Design: Sandwich construction with 45 mm heat and condensation insulation, covered with double aluzinc sheet metal (corrosivity class C4).

Including hinged airtight hatch for fast access.

Filter: Absolute DG 610x610x292 mm.

Integrity test for validation operation : Built-in, non intrusive scanning system for HEPA filter integrity test, including 100% concentration measurement ports.

Clamping system: Designed not to disturb integrity test operations.

Inspection: Built-in inspection lens and light to survey while performing scanning.

Performance:

Leakage class D according to EN 15727:2010 standard.

Leakage class L1 according to EN 1886:2007 standard.

Mechanical: D1 according to EN 1886:2007 standard.

Max penetration gasket frame (filter section) < 0,01% by ISO 14644-3.

Fulfills the regulatory demands on HEPA-filter integrity test according to ISO 14644-3.

Model Name	Dimensions WxHxD (mm)	Duct connection (mm)	Weight (kg)
CamCube AS 1010	707x707x650	615x615	43
CamCube AS 1020	707x1322x650	615x1230	64

Model Name	Dimensions WxHxD (mm)	Duct connection (mm)	Weight (kg)
CamCube AS 1030	707x1937x650	615x1845	85
CamCube AS 2010	1322x707x650	1230x615	62
CamCube AS 2020	1322x1322x650	1230x1230	86
CamCube AS 2030	1322x1937x650	1230x1845	109

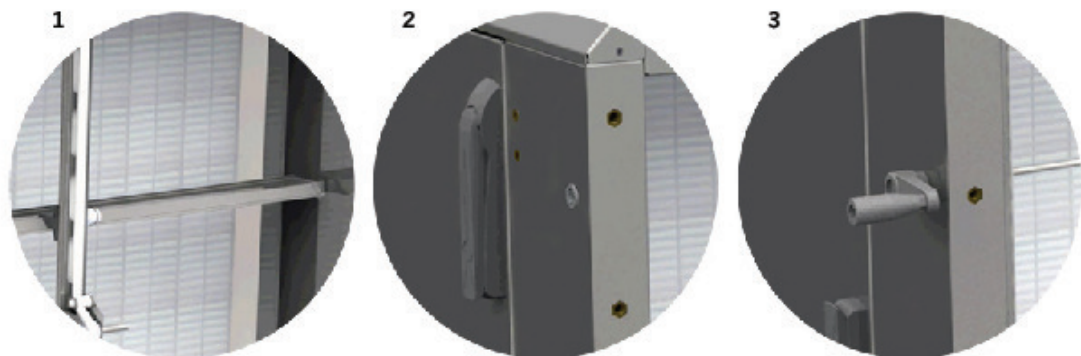
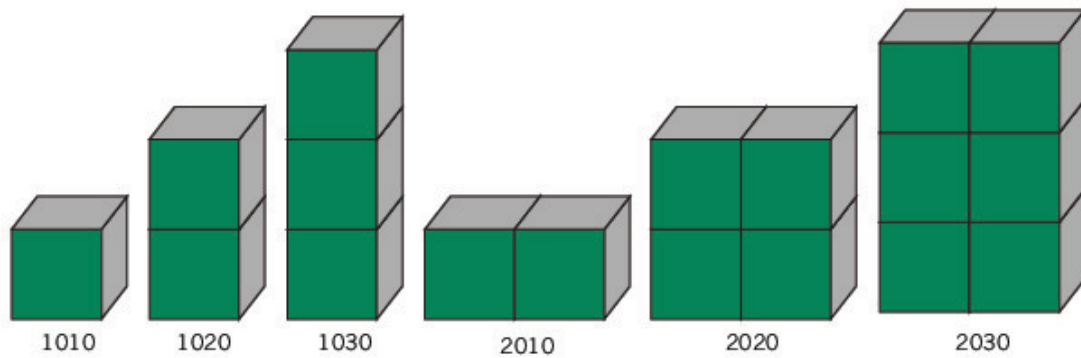
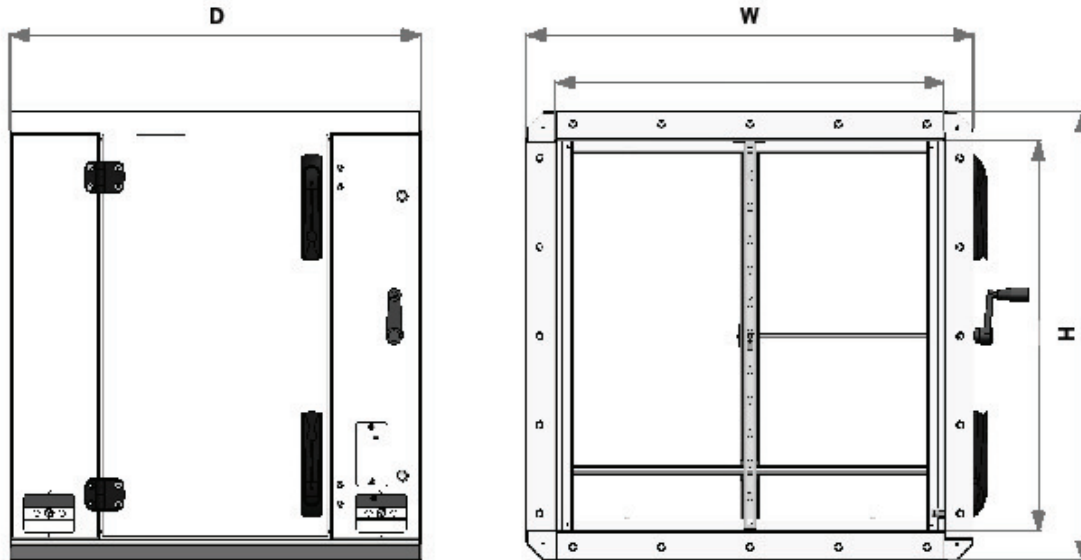

1. Advanced patented probe 2. Optical wide angle inspection lens 3. Crank with foldable handle